



TRUE MANUFACTURING CO., INC.

## Congratulations!

You have just purchased the finest commercial refrigerator available. You can expect many years of trouble-free operation.

## Table of Contents

### Safety Information

Safety Precautions & Proper Disposal.....3

### Installation

Ownership, Location, Wire Gauge Chart .....4

Recommended Operating Conditions .....5

Uncrating.....6

Leveling.....7

Sealing Cabinet to the Floor .....8

Connecting Electricity .....9

### Cabinet Setup

Shelving ..... 10

Shelf Light Installation, Price Strip ..... 11

Night Cover ..... 12

### Cabinet Operation

Startup..... 13

Sequence of Operation ..... 14

### Maintenance, Care & Cleaning

Cleaning the Condenser Coil ..... 15

Stainless Steel Equipment Care & Cleaning ..... 17

### Cabinet Adjustments

Condensate Pan Drain Connection ..... 18

Servicing and Replacement Components ..... 18

### Warranty

Warranty ..... 19



## INSTALLATION MANUAL OPEN AIR MERCHANDISER



TOAM-30GS-HC~TSL01



TOAM-48GS-HC~TSL01



TOAM-72-HC~TSL01



## INSTALLATION MANUAL OPEN AIR MERCHANDISER

Original Instructions

### TRUE MANUFACTURING CO., INC.

2001 East Terra Lane • O'Fallon, Missouri 63366-4434

(636)-240-2400 • FAX (636)-272-2408 • International FAX (636)272-7546 • (800)-325-6152

Parts Department (800)-424-TRUE • Parts Department FAX# (636)-272-9471

#### North America – Canada and Caribbean

Warranty Phone: +1 855 878 9277

Warranty Fax: +1 636 980 8510

Technical Phone: +1 855 372 1368

Warranty Email:

warrantyinquiries@truemfg.com

Technical Email:

service@truemfg.com

7:00 – 7:00 CST Monday – Thursday.

7:00 – 6:00 Friday, 8:00 – 12:00 Saturday.

#### Mexico

Phone: +52 555 804 6343/44

Toll Free in Mexico: 01 800 202 0687

service-mexicocity@truemfg.com

9:00 am – 5:30 pm M–F

#### Latin America

Phone: +56 232 13 3600

servicelatam@truemfg.com

9:00 am – 5:30 pm M–F

#### UK, Ireland, Middle East, Africa and India

Phone: +44 (0) 800 783 2049

service-emea@truemfg.com

8:30 am – 5:00 pm M–F

#### European Union and Commonwealth of Independent States

Phone: +49 (0) 7622 6883 0

service-emea@truemfg.com

8:00 am – 5:00 pm M–F

#### Australia

Phone: +61 2 9618 9999

service-aus@truemfg.com

8:30 am – 5:00 pm M–F



811470-C



## How to Maintain Your True Refrigerator to Receive the Most Efficient and Successful Operation

You have selected one of the finest commercial refrigeration units made. It is manufactured under strict quality controls with only the best quality materials available. Your TRUE cooler, when properly maintained, will give you many years of trouble-free service.

**WARNING** – Use this appliance for its intended purpose as described in this Installation Manual.

### Refrigerant Safety & Warning Information

See the serial label inside the cabinet for the units refrigeration type. For Hydrocarbon Refrigeration (R290 only), see below:



**DANGER** – Risk of fire or explosion. Flammable refrigerant used. **DO NOT** use mechanical devices to defrost refrigerator. **DO NOT** puncture refrigerant tubing; follow handling instructions carefully. To be repaired only by trained service personnel.



**DANGER** – Risk of fire or explosion (flammable refrigerant used), consult repair manual/owner's guide before attempting to service this product. All safety precautions must be followed. Dispose of properly in accordance with local and federal regulations. Follow all safety precautions.

**CAUTION** – Keep all ventilation openings clear of obstruction in the appliance enclosure or in the structure housing the appliance.

### Basic Safety & Warning Precautions

- Take care during operation, maintenance or repairs to avoid cuts or pinching from any part/component of the cabinet.
- Units may pose a tipping hazard while uncrating, during installation, or when moving the unit.
- Ensure the unit is properly installed and located in accordance with the Installation Instructions before use.
- This appliance is not to be used, cleaned or maintained by persons (including children) with reduced physical, sensory or mental capabilities or lack of experience and knowledge, unless they have been given supervision or instruction.
- **DO NOT** allow children to play with the appliance or climb, stand, or hang on the unit's shelves to prevent damage to the refrigerator and personal injury.
- **DO NOT** touch the cold surfaces in the freezer compartment when hands are damp or wet. Skin may stick to these extremely cold surfaces.
- Unplug the refrigerator before cleaning and making repairs.
- Setting temperature controls to the 0 position or powering off an electronic control may not remove power from all components (e.g., light circuits, perimeter heaters, and evaporator fans).
- **DO NOT** store or use gasoline, or other flammable vapors and liquids, in the vicinity of this or any other appliance.
- **DO NOT** store explosive substances such as aerosol cans with a flammable propellant in this appliance.
- Keep fingers out of the "pinch point" areas; clearances between the doors and cabinet are necessarily small; be careful closing doors when children are in the area.
- **DO NOT** use electrical appliances inside the food storage compartments of the units unless the appliances are of the type recommended by the manufacturer.

**NOTE:** All servicing must be performed by a qualified technician.

### Cabinet Disposal Warning

**DANGER!**  
**RISK OF CHILD**  
**ENTRAPMENT**



#### Proper Disposal of the Cabinet

Child entrapment and suffocation are not problems of the past. Junked or abandoned refrigerators are still dangerous, even if they will sit for "just a few days." If you are getting rid of your old refrigerator, please follow the instructions below to help prevent accidents.

#### Before throwing away your old refrigerator or freezer:

- Take off the doors.
- Leave the shelves in place so that children may not easily climb inside.



**DANGER** – Risk of fire or explosion. Flammable insulation and/or refrigerant used. Dispose of all in accordance with local and federal regulations. Follow all safety precautions.

# Installation

## Prior to Installation

### Ownership

To ensure that your unit works properly from the first day, it must be installed properly. We highly recommend a trained refrigeration mechanic and electrician install your TRUE equipment. The cost of a professional installation is money well spent.

Before you start to install your TRUE unit, carefully inspect it for freight damage. If damage is discovered, immediately file a claim with the delivery freight carrier.

TRUE is not responsible for damage incurred during shipment.

### Cabinet Specification

This appliance is rated for the storage and/or display of prepackaged or bottled food product.

### Cabinet Location

- Appliance tested for IEC to ISO Climate Class 8 [75°F (24°C) temperature, 55% relative humidity].
- Appliance is not suitable for an area where a pressure washer or hose may be used.
- Ensure the location will provide adequate clearances and sufficient airflow for the cabinet.
- Ensure the power supply for the cabinet matches the cabinet specification sheet or cabinet data plate and is within the rated voltage (+/-5%). Also, that the amp rating of the circuit is correct and that it is properly grounded.
- The cabinet should always be plugged into its own individual dedicated electrical circuit. The use of adapter plugs and extension cords is prohibited.

### Notice to Customer

Loss or spoilage of products in your refrigerator/freezer is **not covered by warranty**. In addition to following recommended installation procedures, you must run the refrigerator/freezer for 24 hours prior to usage to verify its proper operation.



CLEARANCES			
	TOP	SIDES	BACK
TOAM	8" (204 mm)	0" (0 mm)	3" (77 mm)
<b>WARNING</b> – Warranty is void if ventilation is insufficient.			

## Wire Gauge Chart

115 Volts	Distance In Feet To Center of Load												
	AMPS	20	30	40	50	60	70	80	90	100	120	140	160
2	14	14	14	14	14	14	14	14	14	14	14	14	14
3	14	14	14	14	14	14	14	14	14	14	14	14	12
4	14	14	14	14	14	14	14	14	14	14	12	12	12
5	14	14	14	14	14	14	14	14	12	12	12	10	10
6	14	14	14	14	14	14	14	12	12	12	10	10	10
7	14	14	14	14	14	14	12	12	12	10	10	10	8
8	14	14	14	14	14	12	12	12	10	10	10	8	8
9	14	14	14	12	12	12	10	10	10	10	8	8	8
10	14	14	14	12	12	10	10	10	10	10	8	8	8
12	14	14	12	12	10	10	10	8	8	8	8	8	6
14	14	14	12	10	10	10	8	8	8	8	6	6	6
16	14	12	12	10	10	8	8	8	8	8	6	6	6
18	14	12	10	10	8	8	8	8	8	8	8	8	5
20	14	12	10	10	8	8	8	6	6	6	6	5	5
25	12	10	10	8	8	6	6	6	6	6	5	4	4
30	12	10	8	8	6	6	6	6	6	5	4	4	3
35	10	10	8	6	6	6	5	5	4	4	4	3	2
40	10	8	8	6	6	5	5	4	4	4	3	2	2
45	10	8	6	6	6	5	4	4	3	3	3	2	1
50	10	8	6	6	5	4	4	3	3	3	2	1	1

230 Volts	Distance In Feet To Center of Load												
	AMPS	20	30	40	50	60	70	80	90	100	120	140	160
5	14	14	14	14	14	14	14	14	14	14	14	14	14
6	14	14	14	14	14	14	14	14	14	14	14	14	12
7	14	14	14	14	14	14	14	14	14	14	14	14	12
8	14	14	14	14	14	14	14	14	14	14	14	12	12
9	14	14	14	14	14	14	14	14	14	12	12	12	10
10	14	14	14	14	14	14	14	14	12	12	12	10	10
12	14	14	14	14	14	14	14	12	12	12	10	10	10
14	14	14	14	14	14	14	12	12	12	10	10	10	8
16	14	14	14	14	14	12	12	12	10	10	10	8	8
18	14	14	14	12	12	12	10	10	10	10	8	8	8
20	14	14	14	12	10	10	10	10	10	10	8	8	8
25	14	14	12	12	10	10	10	10	10	8	8	6	6
30	14	12	12	10	10	10	8	8	8	8	6	6	6
35	14	12	10	10	10	8	8	8	8	8	6	6	5
40	14	12	10	10	8	8	8	6	6	6	6	5	5
50	12	10	10	8	6	6	6	6	6	6	5	4	4
60	12	10	8	6	6	6	6	6	6	5	4	4	3
70	10	10	8	6	6	6	5	5	4	4	4	2	2
80	10	8	8	6	6	5	5	4	4	4	3	2	2
90	10	8	6	6	5	5	4	4	3	3	3	1	1
100	10	8	6	6	5	4	4	3	3	3	2	1	1

# Installation (cont.)

## Recommended Operating Conditions

- Do not place in direct sunlight.
- No HVAC supply or return air vents pushing air into or pulling air out of the cabinet.
- No ceiling fans.
- No doorways.
- Make sure cabinet is level from front-to-back and side-to-side.

**NOTE:** Check for correct clearance in back of and above the cabinet. A 3" (77 mm) clearance is required at the rear of the cabinet and 8" (204 mm) clearance above the cabinet.

- Maximum ambient conditions 75°F (24°C) or as indicated on the serial label, and 55% relative humidity.
- Place cabinet in an area that will not have any air drafts.
- Excessive airflow around cabinet can effect interior cabinet airflow (air-curtain).

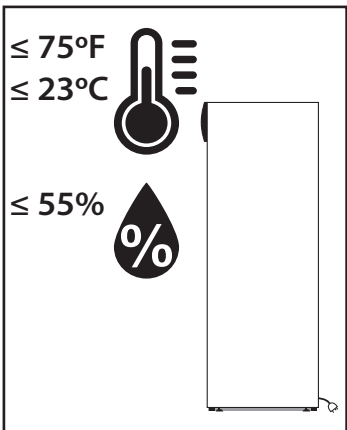
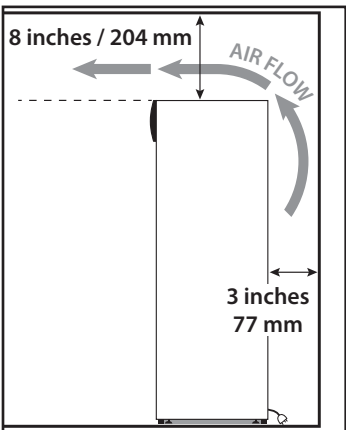
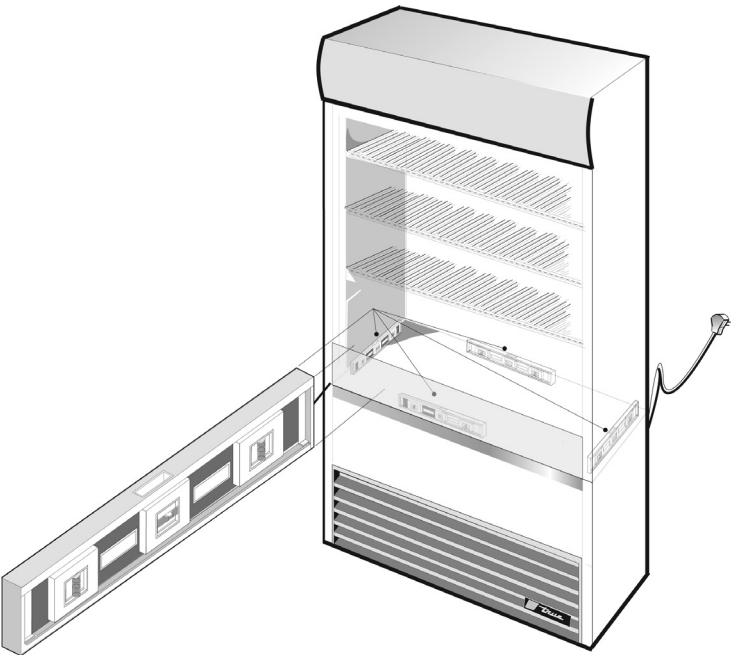
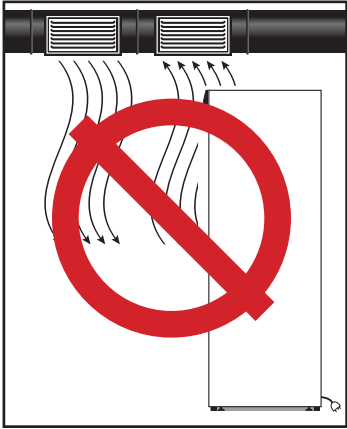
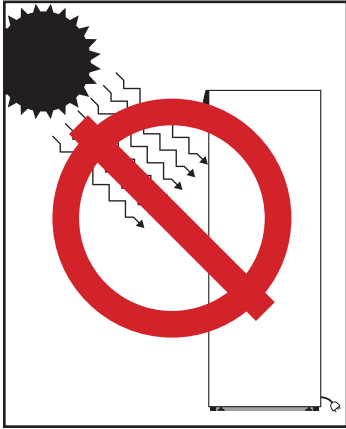

\* Or as indicated on the serial label.

## Installation (cont.)

### Uncrating

#### Tools Required

- Adjustable wrench
- 3/4" socket wrench
- 1/4" socket wrench
- Level

The following procedure is recommended for uncrating the unit:

1. Remove the outer packaging (cardboard and bubbles or styrofoam corners and clear plastic). See fig. 1. Inspect for concealed damage. Again, immediately file a claim with the freight carrier if there is damage.

**NOTE:** Move the unit as close as possible to the final location before removing the wooden skid.

2. With an adjustable wrench, remove all shipping bolts securing the wood skid to the bottom of the cabinet. See fig. 2.

**NOTE:** Some models may require removing the front and/or rear grill to access the shipping bolts. See figs. 3 and 4. Remove the grills with a 1/4" socket wrench, if so equipped.

3. Install the included leveling legs (see Installing Standard Leveling Legs), optional 6" leveling legs or castors (see Installing Optional 6" Leveling Legs or Castors), if so equipped.

**NOTE:** With the shipping bolts removed, rotate the cabinet on the skid to gain access.

If leveling legs or castors are not to be used, remove the cabinet from the wooden skid. Place the skid to the side.

**NOTE:** When lifting the unit, do not use countertops, doors/drawers, or grills as a lifting point. Also, remember to leave cabinet upright for 24 hours before plugging into a power source. Keys for cabinet with door locks are located in the warranty packet.

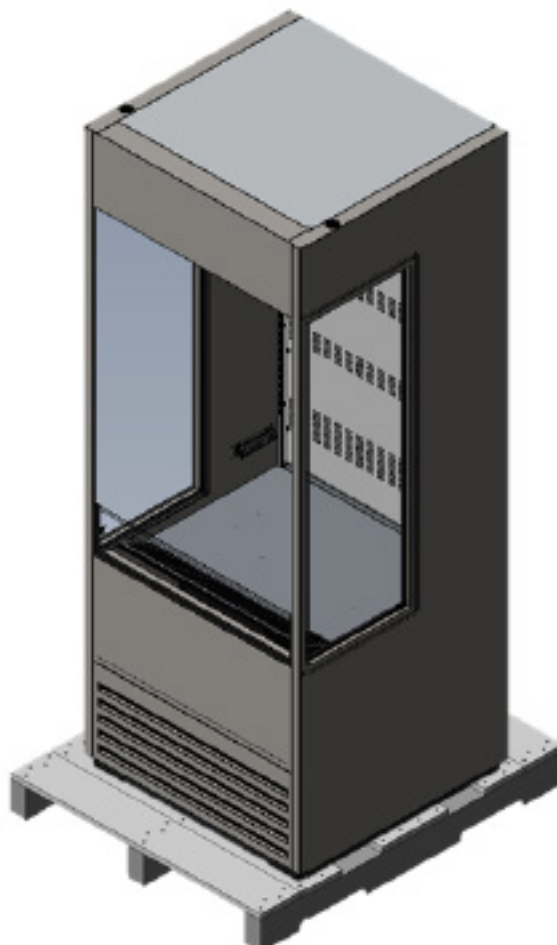

Fig. 1. Remove the outer packaging.

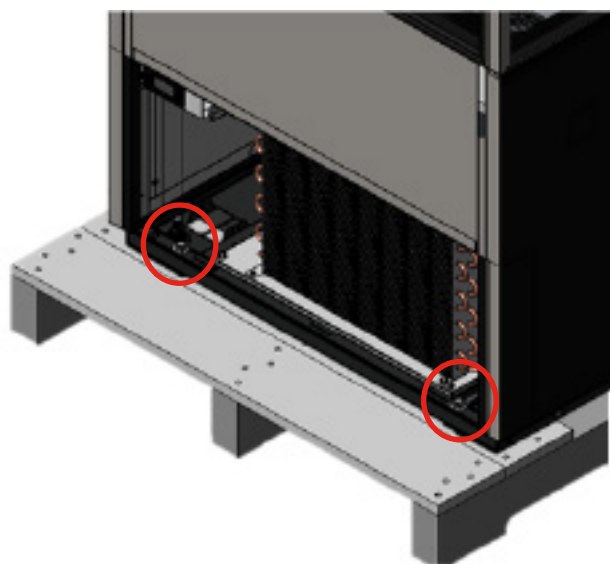

Fig. 2. Remove the skid bolts on the front and back.

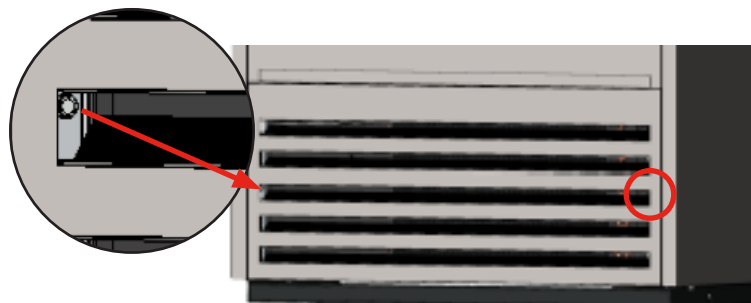

Fig. 3. Remove the screws. Pull the front grill to release it from the magnetic brackets.

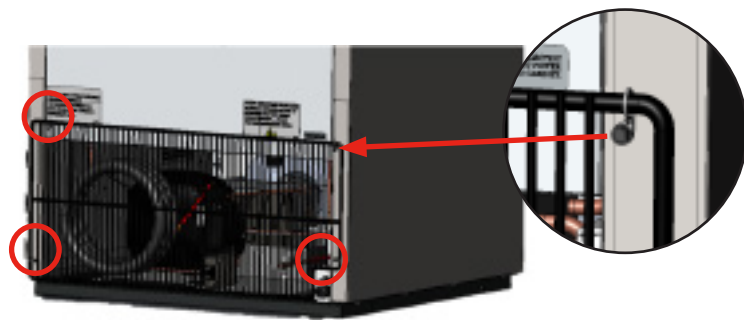

Fig. 4. Remove the screws and detach the rear grill.

# Installation (cont.)

## Cabinet Location

1. Ensure that the drain hose or hoses are positioned in the pan.
2. Free the plug and cord from inside the lower rear of the cooler (**DO NOT** plug in).
3. Place the unit close enough to the electrical supply so that the extension cords are never used.

## Installing Standard Leveling Legs

Leveling legs are provided to assist with the leveling of the cabinet.

1. Access the bottom of the cabinet and locate the leveling legs.
2. The leveling legs may be threaded in or out to achieve a level and supported cabinet. See fig. 1 and 2.

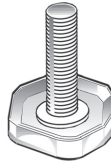

## Installing Optional 6" Leveling Legs or Castors

Optional adjustable legs will provide 6" (152 mm) of clearance under the cabinet. Optional castors will provide cabinet mobility.

### Tools Required

- Adjustable Wrench
- Castor wrench (optional)

### 6" Leveling Legs

1. Access the bottom of the cabinet by carefully laying it on its back. Locate and remove the leveling legs from the 1/2" threaded inserts. See fig. 3.
2. Screw in the leveling legs. See fig. 4.
3. Verify that the cabinet is level. If the cabinet is not level, gently lift and support the low end of the cabinet. Using an adjustable wrench, screw the bottom stem of the leveling leg in or out to level and support the cabinet. See fig. 5.

### Castors

1. Loosen the castor bolt enough to slide the provided castor shims between the castor bearing and the bottom rail of the cabinet. See fig. 6.
2. Install the desired number of shims. If more than one shim is used, turn the slots at a 90° angle to each other, so the slots do not align. See figs. 7 and 8.
3. Tighten and secure the shims and castors with the optional castor wrench. Lower the cabinet and verify that it is level. If the cabinet is not level, repeat the process until the cabinet is level and supported.



**WARNING** – Units may pose a tipping hazard while uncrating, during installation, or when moving the unit.

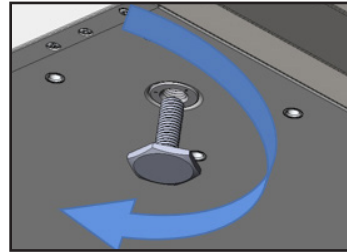

Fig. 1. Turn the leveling legs clockwise to lower the unit.

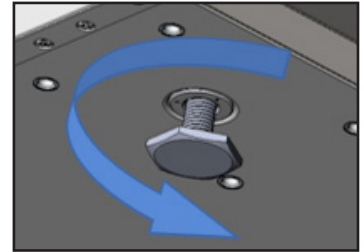

Fig. 2. Turn the leveling legs counterclockwise to raise the unit.

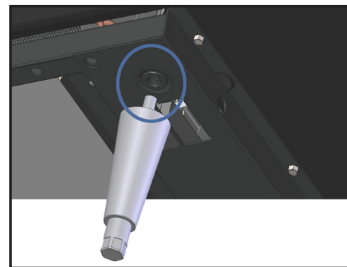

Fig. 3. Locate the threaded hole in the rail.

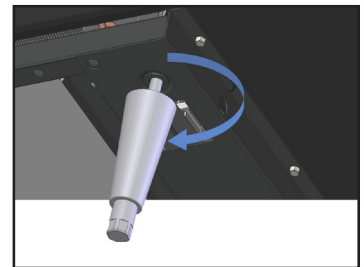

Fig. 4. Screw in the leveling legs.

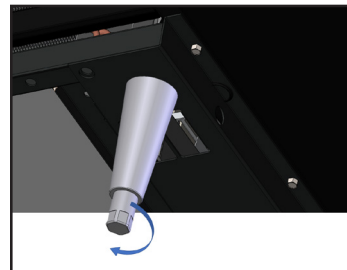

Fig. 5. Turn the bottom stem to level the cabinet.

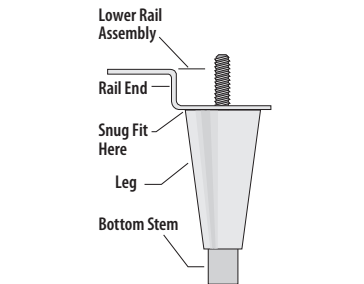

Fig. 6. Loosen castor bolt.



Fig. 7. Install shim(s).



Fig. 8. Position multiple shims at 90° angles.

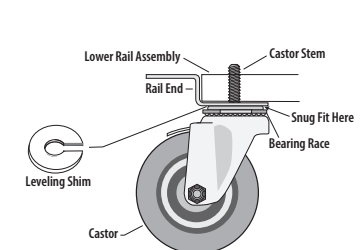

## Installation (cont.)

### Leveling

Proper leveling of your TRUE cooler is critical to operating success (for non-mobile models). Leveling impacts effective condensate removal and door operation.

Level the unit front-to-back and side-to-side.

1. Position the level on the inside floor of the unit (the level should be parallel to cabinet front). Level the cabinet.
2. Position the level at the inside rear of cabinet (again, the level should be placed parallel to cabinet back). Level the cabinet.
3. Perform procedures similar to steps 1 and 2 by placing the level on inside floor (left and right side, parallel to the depth of the cooler). Level the cabinet.

**NOTE:** If the cabinet has a center leveling screw, castor, or leg, make sure it is adjusted properly so it makes full contact with the floor after the cabinet has been leveled.

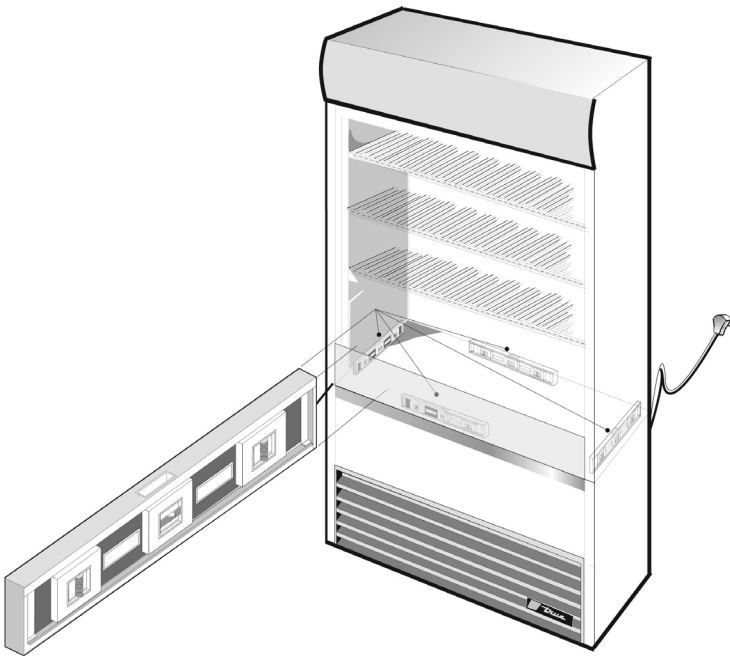

### Sealing the Cabinet to the Floor

Asphalt floors are susceptible to chemical attack. A layer of tape may be placed on the floor prior to applying the sealant to protect the floor.

1. Position the cabinet, allowing 3" (73 mm) between the wall and the rear of the cabinet to ensure proper ventilation.
2. Level the cabinet. The cabinet should be level side-to-side and front-to-back. To check that the cabinet is level, place a carpenter's level on the interior cabinet floor in four places:
  - a. Position the level on the inside floor of the cabinet, near the doors (the level should be placed parallel to the cabinet front). Level the cabinet.
  - b. Position the level at the inside rear of the cabinet (the level should be placed parallel to the cabinet back). Level the cabinet.
  - c. Perform procedures similar to a. and b. by placing the level on the left and right inside floor (level should be parallel to the cabinet sides). Level the cabinet.
3. Draw an outline of the cooler base on the floor.
4. Raise and block the front side of the cabinet.
5. Apply a bead of NSF-approved sealant (see list below) to the floor, 1/2" (13 mm) inside the front part of the outline drawn in step 4. The bead of sealant must be heavy enough to seal the entire cabinet surface when the cabinet is lowered on top of the sealant.
6. Raise and block the rear of the cabinet.
7. Apply sealant to the floor on the other three sides, as outlined in step 5.
8. Examine the cabinet to ensure that it is sealed to the floor around the entire perimeter.

### NSF-Approved Sealants

- 3M #ECU800 Caulk
- 3M #ECU2185 Caulk
- 3M #ECU1055 Bead
- 3M #ECU1202 Bead
- Armstrong Cork – Rubber Caulk
- Products Research Co. #5000 Rubber Caulk
- G.E. Silicone Sealer
- Dow Corning Silicone Sealer

# Installation (cont.)

## Electrical Installation & Safety

### Use of Adapter Plugs

**NEVER USE AN ADAPTER PLUG!** An adapter plug alters the original OEM plug configuration when connecting it to a power source.

TRUE will not warranty any refrigerator/freezer that has been connected to an adapter plug.

### Use of Extension Cords

**NEVER USE AN EXTENSION CORD!** An extension cord is determined to be any component that adds length to the original OEM power cord when connecting it to a power source.

TRUE will not warranty any refrigerator/freezer that has been connected to an extension cord.

### NEMA Plug Configurations

#### 60 HZ USE ONLY!

TRUE uses these types of NEMA plugs shown. If you **DO NOT** have the proper outlet, have a licensed electrician verify and install the correct power source.



### International (IEC) Plugs Only

International cabinets may be supplied with a power cord that will require installation. Install this cord before connecting the unit to a power source.

**NOTE:** International plug configurations will vary by country and voltage

### Installation

Fully seat the power cord into the cabinet receptacle until it locks in position. See fig. 1.

### Removal

Depress the red button. See fig. 2.

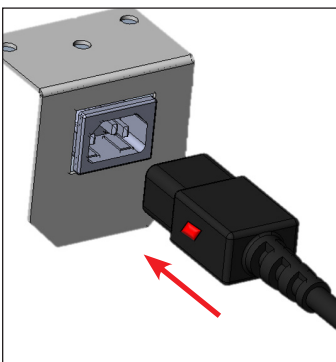

**Fig. 1.** Fully insert the power cord into the receptacle.

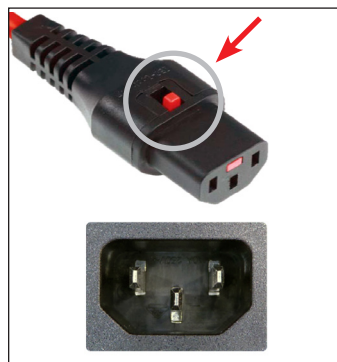

**Fig. 2.** Push the red button to remove the plug.

### How to Connect Electricity

- The power cord from this appliance is equipped with a grounding plug which minimizes the possibility of electric shock hazard.
- The wall outlet and circuit should be checked by a licensed electrician to make sure the outlet is properly grounded.
- If the outlet is a standard 2-prong outlet, it is your personal responsibility and obligation to have it replaced with the properly grounded wall outlet.
- **DO NOT**, under any circumstances, cut or remove the ground prong from the power cord. For personal safety, this appliance must be properly grounded.
- Before your new unit is connected to a power supply, check the incoming voltage with a voltmeter. If the recorded voltage is less than the rated voltage for operation (+/-5%) and amp rating, correct immediately. Refer to cabinet data plate for this voltage requirement.
- The refrigerator/freezer should always be plugged into a dedicated electrical circuit. This provides the best performance and prevents building wiring circuits from being overloaded, which could cause a fire hazard from overheated wires.
- Never unplug your refrigerator/freezer by pulling on the power cord. Always grip plug firmly and pull straight out from the outlet.
- When moving the refrigerator/freezer, for any reason, be careful not to roll over or damage the power cord.
- Repair or replace immediately all power cords that have become frayed or otherwise damaged. **DO NOT** use a power cord that shows cracks or abrasion damage along its length or at either end.
- If the supply power cord is damaged, it should be replaced with original equipment manufacturer (OEM) components. To avoid hazard this should be done by a licensed service provider.

### Cabinet Wiring Diagram

The cabinet's wiring diagram is in the exterior servicing compartment space of the cabinet.

A copy of the wiring diagram may also be obtained at [www. TRUEmfg.com/support/serial-number-lookup](http://www.TRUEmfg.com/support/serial-number-lookup)

## Cabinet Setup

### Shelving Installation

**NOTE: For ease of installation, it is recommended that the lower shelf be installed first.**

1. Install the shelf brackets into the shelf standards.
  - a. Position the shelf bracket in front of the shelf standard. Raise the front of the bracket up at a 45° angle, to allow the bracket support tab to slide into the slot in the shelf standard. See fig. 1.
  - b. Slide the shelf angle adjustment tab into the shelf standard. Position the tab in the shelf bracket to support the shelf at the desired angle.
  - c. Repeat a. and b. for the shelf bracket on the other side.
2. Install the shelves onto the shelf brackets.
  - a. Position the shelf on the shelf brackets. The horizontal bends on the left and right sides of the shelf should be to the outside of the brackets.
  - b. Move the back of the shelf up and back until the front of the shelf clears the shelf support tab on the shelf bracket. See fig. 2.
  - c. Once the shelf has cleared the shelf support tab, slide the shelf forward until the front of the shelf is under the front shelf support tab. When installed correctly, the shelf will be supported between the notched areas in the shelf brackets. See fig. 3.
  - d. Repeat a, b and c for additional shelves.

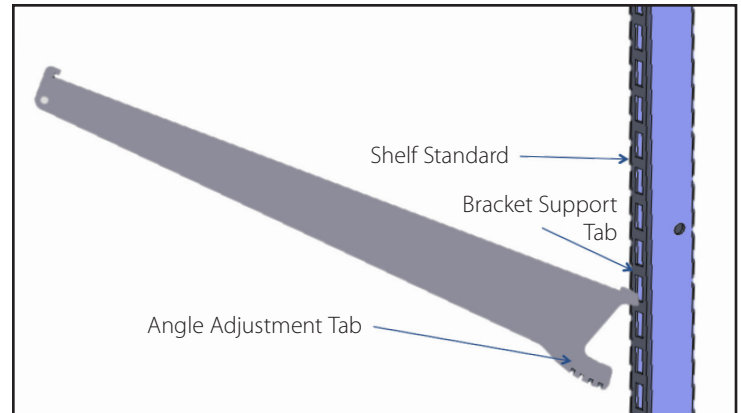

**Fig. 1.** Install the shelf brackets.

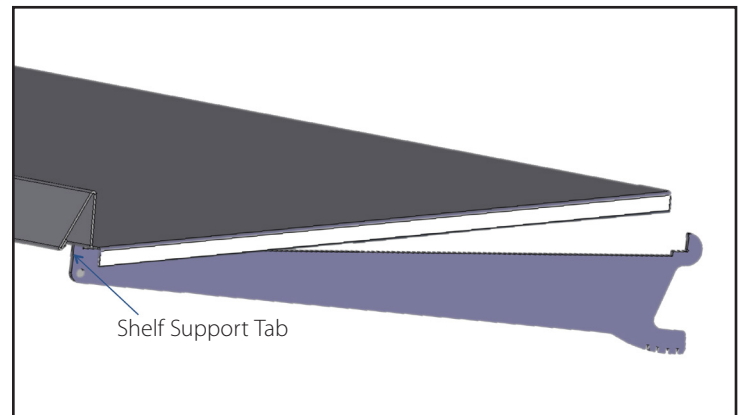

**Fig. 2.** Install the shelves

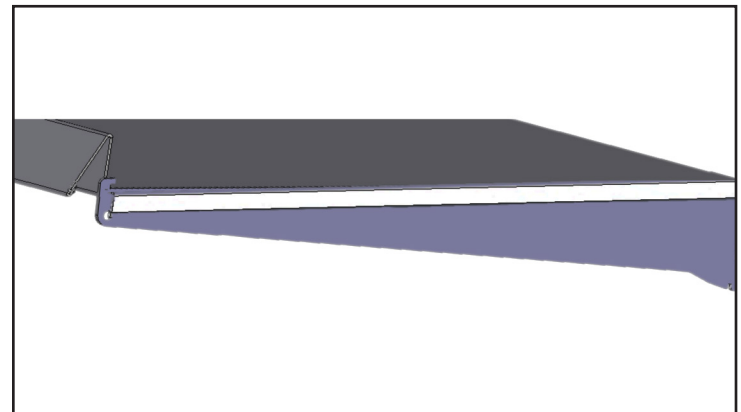

**Fig. 3.** Correct shelf installation

### Shelf Adjustments

Shelving is adjustable for customer application. This cabinet meets the IEC Shelf Weight Capacity of 47lb/ft<sup>2</sup> (230kg/m<sup>2</sup>).

**WARNING** – Remember to follow the guidelines below when loading product.

- When loading, product may **NOT** block the air flow from the top (honeycomb) or at the bottom (stainless steel evaporator cover).
- Product may **NOT** extend over the front edge of the shelves.

# Cabinet Setup (cont.)

## Shelf Light Installation

1. Locate the LED power cord protruding from the inner back wall. See fig.1.
2. Gently pull the power cord and route it to the LED module, located under the front lip of the shelf. See fig. 2.
3. Insert the power cord into the LED module. See fig. 3.
4. Secure the power cord to the J-clip retainer on the shelf bracket. See fig. 4.

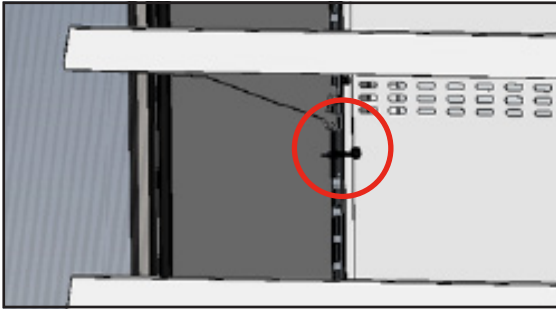

Fig. 1. Locate the LED power cord.

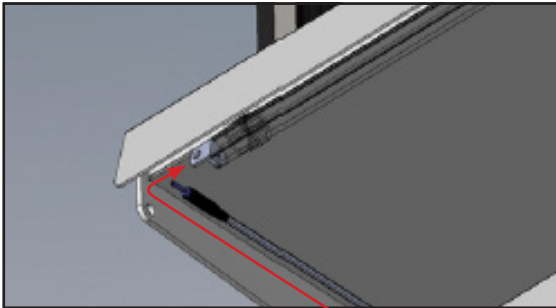

Fig. 2. Route the power cord to the LED module.

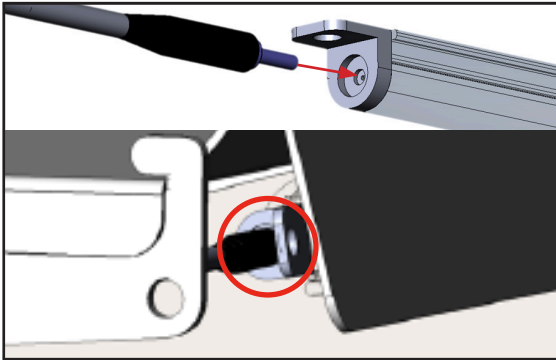

Fig. 3. Insert the power cord into the LED module.

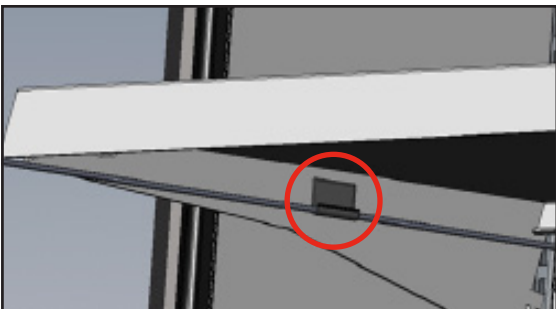

Fig. 4. Secure the power cord.

## Price Strip Installation

1. Holding the price strip and looking down its length from one end, notice the larger (top) opening, and the smaller (bottom) opening. See fig.1.
2. Position the price strip across the front of the shelf, with the large opening at the top and the smaller opening snapped over the bottom edge of the shelf. See fig. 2.
3. Snap the top of the price strip over the top of the shelf. See fig. 3. Price tags can now be inserted into the channel in the price strip.

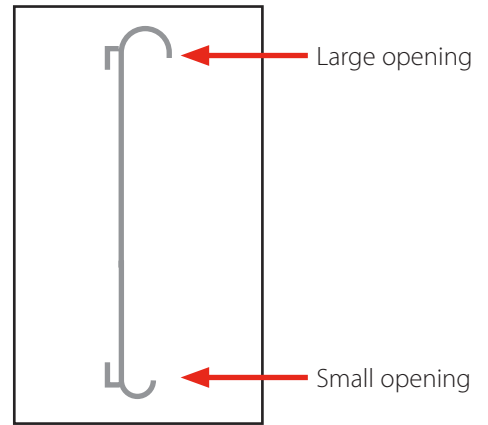

Fig. 1. The large and small openings in the price strip.

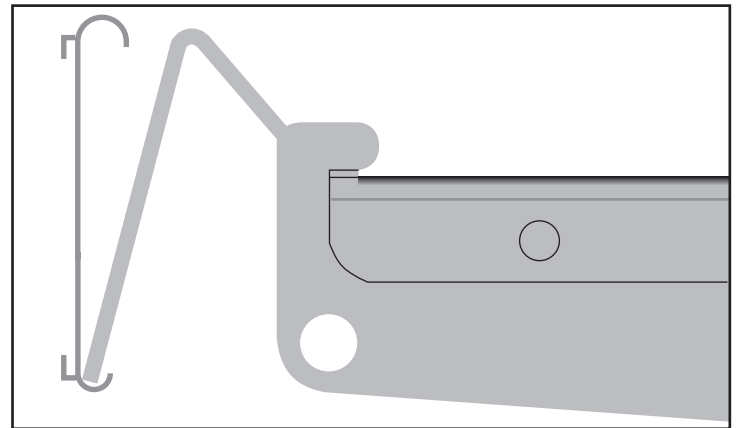

Fig. 2. Proper positioning of the shelf strip during installation.

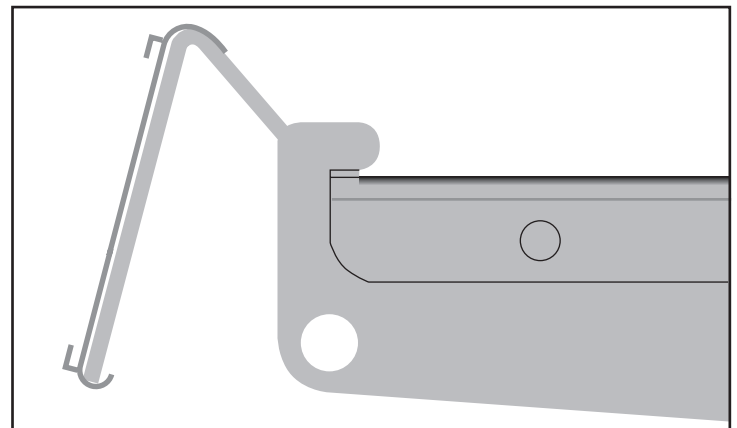

Fig. 3. Correct installation of the price strip.

## Cabinet Setup (cont.)

### Night Cover Operation

**NOTE:** It is recommended that the night cover be used during overnight or extended off-peak business times to conserve energy.

1. Locate the night cover handle on the inner front product floor. See fig. 1.
2. Pull the night cover toward the top of the product opening. See fig. 2.
3. Secure the night cover in place by placing the handle on the hook at the top of the product opening. See fig. 3.
4. To lower the night cover, lift the handle off the hook and gently guide the night cover down, keeping tension on the night cover and allowing it to retract into the product floor.

**WARNING** – Do not release the night cover handle from your hand until the cover is completely retracted.

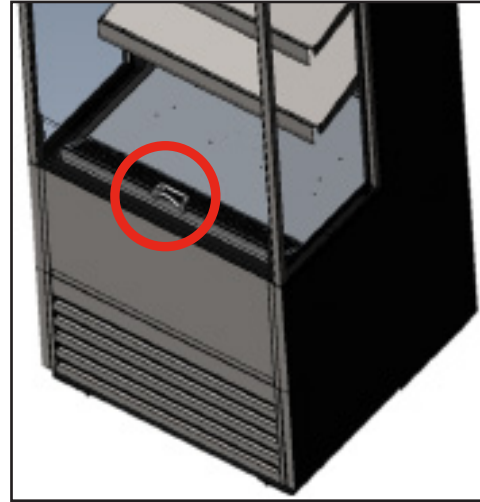

Fig. 1. Locate the night cover handle.

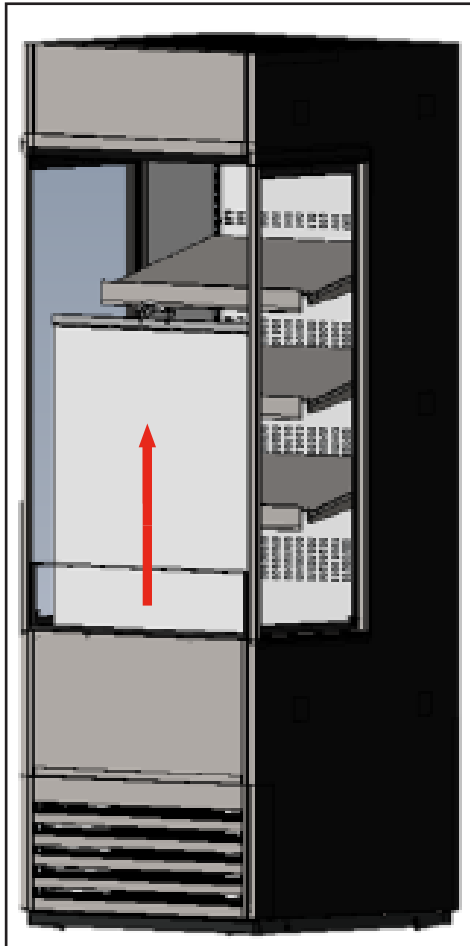

Fig. 2. Pull the handle toward the top of the product opening.

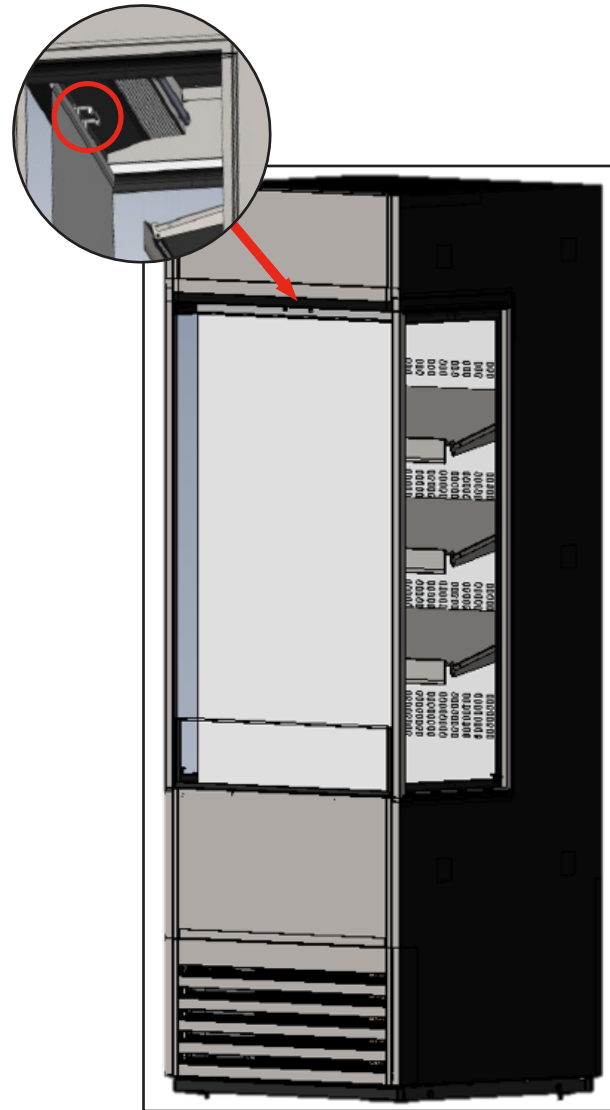

Fig. 3. Secure the cover in place.

# Cabinet Operation



## Startup

- The compressor is ready to operate when the unit is purchased. All you need to do is plug in the cooler.
- Excessive tampering with the control could lead to service difficulties. If replacing the temperature control is ever needed, be sure to order the replacement from your TRUE dealer or recommended service agent.
- Good air flow inside your TRUE unit is critical. Take care to prevent product from pressing against the sides or back wall and coming within 4" (101.6 mm) of the evaporator housing. Refrigerated air off the evaporator coil must circulate throughout the cabinet for even product temperatures.

**NOTE:** If the unit is disconnected or shut off, wait 5 minutes before restarting.

**RECOMMENDATION** – Before loading product, run your TRUE unit empty for 24 hours to verify proper operation. Remember, our factory warranty **DOES NOT** cover product loss!

## Temperature Control & Light Switch Location

The light symbol  shows the approximate location of the light switch. 

Light Switch  
In front of the top air flow honeycomb..



Electronic Temperature Control  
Behind the front grill OR through the front grill.

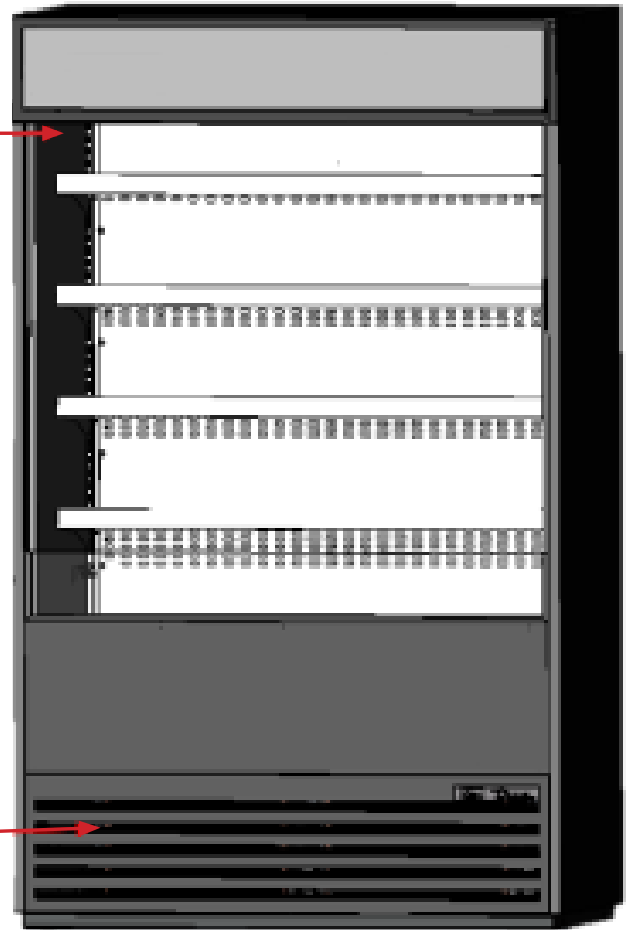

### FOR MORE INFORMATION

For more information regarding a cabinets general sequence of operation, including basic temperature control adjustments, please visit our website:

[www.truemfg.com/support/resource-library](http://www.truemfg.com/support/resource-library)

## Cabinet Operation (cont.)

### Refrigerator and Freezer Cabinets

#### When the cabinet is plugged in

- Interior lights will illuminate on glass door models (see previous page for light switch location).
- An electronic control with digital display will illuminate (if installed).
- There may be a short delay before the compressor and/or evaporator fan(s) start. This delay may be determined by time or by temperature, which could be the result of an initial defrost event that will last at least 6 minutes.
- The temperature control/thermostat may cycle the compressor and evaporator fan(s) on and off together. Every cabinet will require a defrost event to ensure the evaporator coil remains clear of frost and ice buildup. Defrost is initiated by a defrost timer or by the electronic control.

**EXCEPTION** – Models TSID, TDBD, TCGG, and TMW do not have an evaporator fan(s).

- The temperature control/thermostat senses either an evaporator coil temperature or air temperature, NOT product temperature.
- An analog thermometer, digital thermometer, or electronic control display may reflect the refrigeration cycle swings of up and down temperatures, NOT product temperature. **The most accurate method to determine a cabinet's operation is to verify the product temperature.**
- Refrigerators with mechanical temperature controls will defrost during every compressor off-cycle.
- Freezers with mechanical temperature controls will defrost by time initiation as determined by a defrost timer.

**EXCEPTION** – Models TFM, TDC, THDC and TMW require a manual defrost. The frequency of this manual defrost will depend on the cabinet's usage and ambient conditions.

- An electronic control with a digital display (if installed) will show **def** during defrost.

**NOTE:** The display may have a short delay before showing a temperature after a defrost event has expired and instead show **def** during a refrigeration cycle.

- Models with an analog or digital thermometer may show higher than normal temperatures during defrost.
- A refrigerator will use the evaporator fans to clear the coil during defrost.

**EXCEPTION** – Models TSID, TDBD, and TCGG do not have an evaporator fan(s).

- A freezer will use heaters to clear the evaporator coil during defrost.

**NOTE:** The evaporator coil heater and drain tube heater are only energized during defrost. Defrost is terminated when a specific evaporator coil temperature is reached or by a time duration.

## Maintenance, Care & Cleaning

**CAUTION** - Take care during operation, maintenance or repairs to avoid cuts or pinching from any cabinet part/component.

### Cleaning the Condenser Coil

When using electrical appliances, basic safety precautions should be followed, including the following:



**WARNING** – **DO NOT** clean appliance with a pressure washer or hose.



**CAUTION** – Fins are sharp. Caution must be used to avoid eye injury. Eye protection is recommended.

### Tools Required

- 1/4" nut driver
- 3/8" nut driver
- Stiff bristle brush
- Tank of compressed air
- Vacuum cleaner
- Flashlight
- Eye protection

1. Disconnect power to unit.
2. Remove the screw securing the louvered grill to the cabinet. See fig. 1.
3. Pull on the grill assembly to release it from the magnetic brackets. See fig. 2.
4. Carefully clean off accumulated dirt from the front fins of the condensing coil with a stiff bristle brush. See fig. 3.
5. With dirt removed from the surface of the coil, use a flashlight to verify that you can see through the coil and observe the condenser fan blade spinning. See fig. 4.

If the view is clear, reinstall louvered grill, connect unit to power and verify operation.

**If the view is still blocked with dirt, proceed to step 6.**

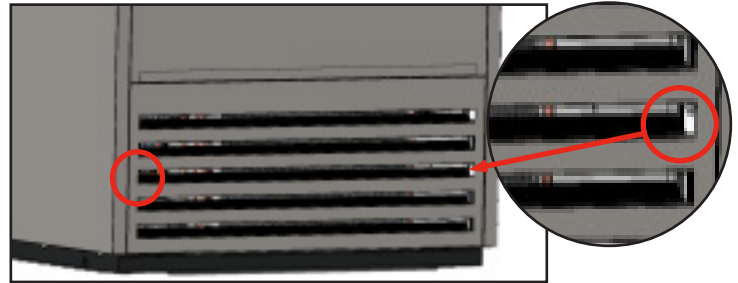

**Fig. 1.** Remove the screw securing the front grill.

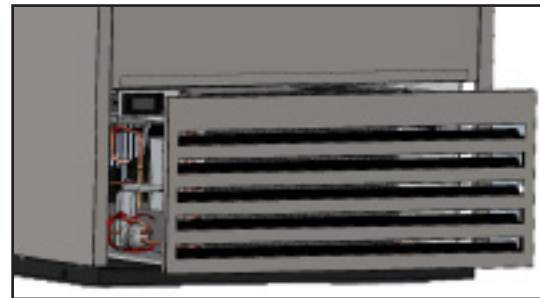

**Fig. 2.** Remove the grill.

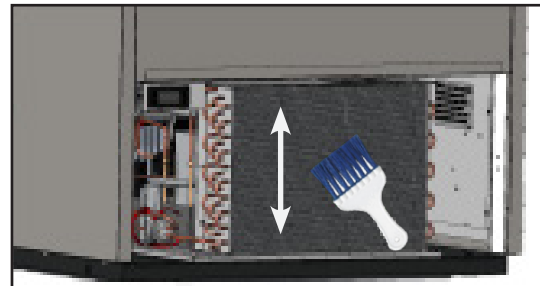

**Fig. 3.** Clean the condensing coil.

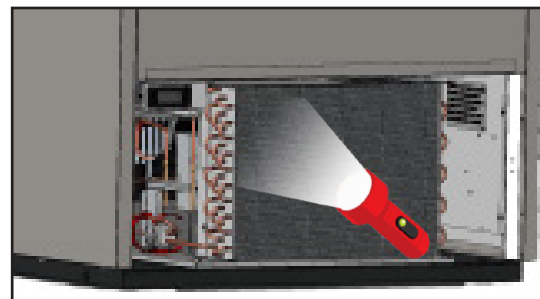

**Fig. 4.** Verify that the coil is clean.

## Maintenance, Care & Cleaning (cont.)

### Cleaning the Condenser Coil (cont.)

6. Remove the condenser base bolts. See fig. 5.
7. Rotate the front of the condensing unit to the left to allow the compressor to clear the condensate drain hose fitting. See fig.6.
8. Carefully slide the condensing unit out (tubing connections are flexible). Gently blow compressed air or CO<sub>2</sub> through the coil until it is clean.
9. Carefully vacuum any dirt around and behind the condensing unit area.
10. Carefully slide the compressor assembly back into position and replace the bolts. See fig. 7.
11. Reinstall the louvered grill, connect power to the unit, and verify operation.

### Important Warranty Information

#### **THE CLEANING OF THE CONDENSER IS NOT COVERED BY WARRANTY!**

If you have any questions, please contact your local TRUE Manufacturing Service Department. See the front cover for locations and contact information.

- Condenser coils accumulate dirt and require cleaning every 30 days or as needed.
- A dirty condenser coil can result in non-warranted repairs and/or cabinet failure.
- Proper cleaning involves removing dust from the condenser by using a soft brush, vacuuming the condenser with a shop vac, or using CO<sub>2</sub>, nitrogen or pressurized air.
- Do not place any filter material in front of the condensing coil.
- On most units, the condenser is accessible by removing the cabinet's outer grill cover.
- If you cannot remove the dirt adequately, please contact your licensed refrigeration service provider.

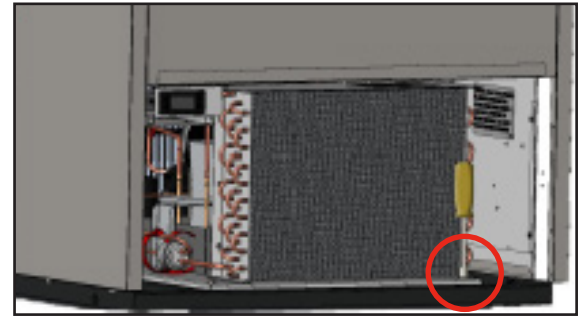

**Fig. 5.** Remove the bolts securing the condenser base.

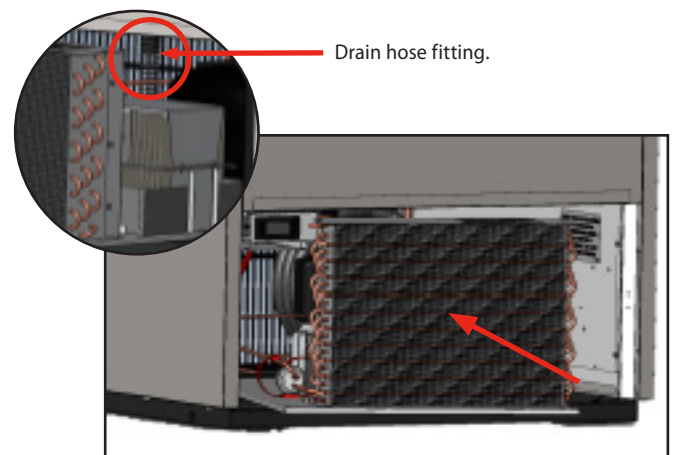

**Fig. 6.** Rotate the condensing unit to the left.

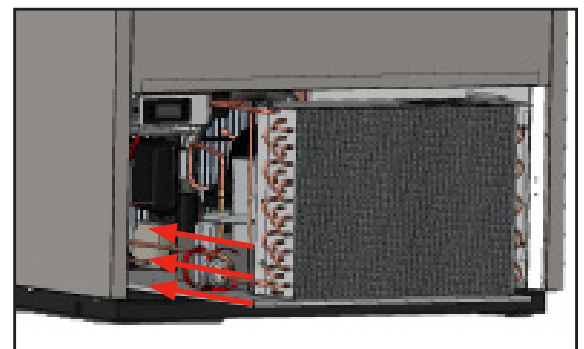

**Fig. 7.** Replace the condenser assembly.

## Maintenance, Care & Cleaning (cont.)

### Stainless Steel Care & Cleaning

**CAUTION** – **DO NOT** use any steel wool, abrasive or chlorine-based products to clean stainless steel surfaces.

### Stainless Steel Opponents

There are three basic things which can break down your stainless steel's passivity layer and allow corrosion to form.

- Scratches from wire brushes, scrapers, steel pads, and other items that can be abrasive to stainless steel's surface.
- Deposits left on your stainless steel can leave spots. You may have hard or soft water depending on what part of the country you live in. Hard water can leave spots. Hard water that is heated can leave deposits if left to sit too long. These deposits can cause the passive layer to break down and rust your stainless steel. All deposits left from food prep or service should be removed as soon as possible.
- Chlorides which are present in table salt, food and water, as well as in household and industrial cleaners. These are the worst type of chlorides to use on stainless steel.

### Stainless Steel Cleaning and Restoration

**DO NOT** use stainless steel cleaners or similar solvents to clean plastic or powder-coated parts. Instead, use warm soapy water.

- For routine cleaning and removal of grease and oil, apply white vinegar, ammonia, or any good commercial detergent\* with a soft cloth or sponge.
- Stainless steel polish (e.g., Zep® Stainless Steel Polish, Weiman® Stainless Steel Cleaner & Polish, Nyco® Stainless Steel Cleaner & Polish, or Ecolab® Ecoshine®) and olive oil can act as a barrier against fingerprints and smears.
- Degreasers\* (e.g., Easy-Off® Specialty Kitchen Degreaser or Simple Green® Industrial Cleaner & Degreaser) are excellent for removal of grease, fatty acids, blood and burnt-on foods on all surfaces.  
**\*DO NOT** use detergents or degreasers with chlorides or phosphates.
- For restoration/passivation or removing stubborn stains and discoloration, Brillo® Cameo®, Zud® Cleanser, Ecolab® Specifax™ First Impression® Metal Polish, Sheila Shine, or talc can be applied by rubbing in the direction of the polish lines.

**NOTE:** The use of proprietary names is intended for example only and does not constitute or imply an endorsement. Omission of proprietary cleansers from this list does not imply inadequacy.

### 8 Tips to Help Prevent Rust on Stainless Steel

#### Maintain the Cleanliness of Your Equipment

Avoid build-up of hard stains by cleaning frequently. Use cleaners at the recommended strength (alkaline chlorinated or non-chloride).

#### Use the Correct Cleaning Tools

Use non-abrasive tools when cleaning your stainless steel products. The stainless steel's passive layer will not be harmed by soft cloths and plastic scouring pads.

#### Clean Along Polishing Lines

Polishing lines ("grain") are visible on some stainless steels. Always scrub parallel to polishing lines when visible. Use a plastic scouring pad or soft cloth when you cannot see the grain.

#### Use Alkaline, Alkaline-Chlorinated or Non-Chloride Cleaners

While many traditional cleaners are loaded with chlorides, the industry is providing an ever increasing choice of non-chloride cleaners. If you are not sure of your cleaner's chloride content, contact your cleaner supplier. If they tell you that your present cleaner contains chlorides, ask if they have an alternative. Avoid cleaners containing quaternary salts, as they can attack stainless steel, causing pitting and rusting.

#### Rinse

When using chlorinated cleaners, you must rinse and wipe dry immediately. It is better to wipe standing cleaning agents and water as soon as possible. Allow the stainless steel equipment to air dry. Oxygen helps maintain the passivity film on stainless steel.

#### Never Use Hydrochloric Acid (Muriatic Acid) on Stainless Steel

Even diluted, hydrochloric acid can cause corrosion, pitting and stress corrosion cracking of stainless steel.

#### Water Treatment

To reduce deposits, soften hard water when possible. Installation of certain filters can remove corrosive and distasteful elements. Salts in a properly maintained water softener can also be to your advantage. Contact a treatment specialist if you are not sure of the proper water treatment.

#### Regularly Restore & Passivate Stainless Steel

Stainless steel gets its stainless properties from the protective chromium oxides on its surface. If these oxides are removed by scouring, or by reaction with harmful chemicals, then the iron in the steel is exposed and can begin to oxidize, or rust. Passivation is a chemical process that removes free iron and other contaminants from the surface of stainless steel, allowing the protective chromium oxides to re-form.

## Cabinet Adjustments, Servicing & Component Replacement

**NOTE:** Any cabinet adjustments are to be made **AFTER** the cabinet has been verified level and properly supported.

### Use of Adapter Plugs

When operating the cabinet outside of the recommended operating conditions, the condensate drain pan(s) may over-fill with water. If this happens, it may be necessary to connect the condensate drain pan(s) to an existing floor drain (if available on location) or install optional electric heated condensate pan(s).

Cabinet size may determine whether one, two, or three condensate pans are used. Follow the steps below for each condensate pan.

### Routing Excess Condensation to a Floor Drain

1. Gain access to the rear of the cabinet and disconnect power to the cabinet.
2. Remove the rear wire grill. See fig. 1.
3. Locate the 45° fitting, located at the top of the condensate pan. Connect a 1/2" (12.7 mm) i.d. vinyl hose to the fitting.
4. Route the drain hose either under the cabinet or through the wire grill, and then to the floor drain.
5. Reinstall the wire grill.
6. Restore power to the cabinet.

### Servicing & Replacing Components

- Replace component parts with OEM (original equipment manufacturer) components.
- Have a licensed service provider service your unit to minimize the risk of possible ignition due to incorrect parts or improper service and to ensure the operator's health and safety.
- Unplug the refrigerator/freezer before cleaning or making any repairs. Setting temperature controls to the 0 position or powering off an electronic control may not remove power from all components (e.g., light circuits, perimeter heaters, and evaporator fans).

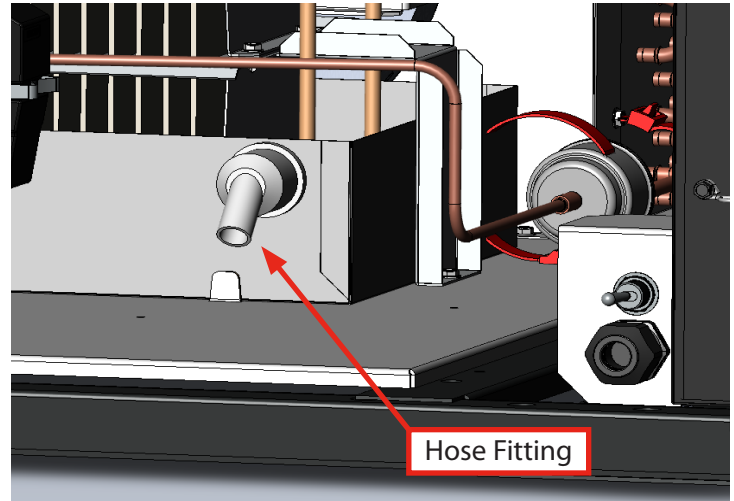

**Fig. 1.** Back of cabinet with wire grill removed.

#### FOR MORE INFORMATION

For additional maintenance instruction, please visit the media center at

[www.truemfg.com](http://www.truemfg.com)

# Warranty Information

To view and download the  
Warranty Information for USA & Canada,  
please scan the QR code below.





[www.truemfg.com](http://www.truemfg.com)